

**ACCOMMODATION OPTIONS**

***Our home can be yours – Embracia in Burpengary***

*Our sophisticated and classically designed home, is surrounded by beautiful and thoughtfully designed landscaped gardens, and internal courtyards.*

*Our private suites are designed to optimise your privacy, whilst providing easy access to your household community, and streetscape.*

*The streetscape with library, café, hairdressers, chapel and games room, are all centrally located in the home.*

*Embracia in Burpengary comprises 6 communities with open-plan living areas, & cosy sitting rooms. Two of these communities are dedicated memory support households, designed to support each resident living with the memory loss associated with dementia.*

*There are 3 Accommodation options available at Embracia in Burpengary.*

**Suites – 25m<sup>2</sup> - 31m<sup>2</sup>**

- ▶ private single bedroom, with sitting area
- ▶ wall mounted flat screen TV
- ▶ built in robes
- ▶ ensuite bathroom
- ▶ optional phone connection
- ▶ 24 hour nurse call system
- ▶ in-room split system air-conditioning, for personal temperature control

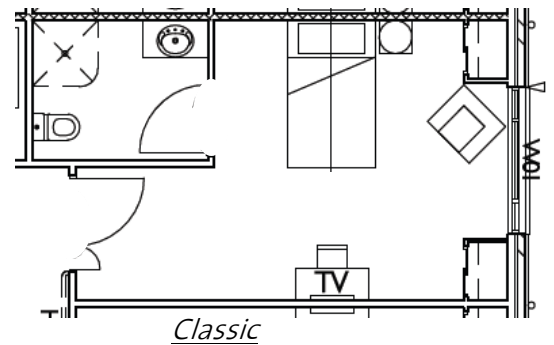

Suite:	<i>Classic</i>	<i>Ambient</i>	<i>Promenade</i>
<i>Room description</i>	<p>A spacious private single bedroom with private ensuite.</p> <p>Beautiful views to our architecturally designed landscape gardens.</p>	<p>A spacious private single bedroom with private ensuite.</p> <p>Private access door leading to the household's landscaped gardens or courtyard.</p>	<p>A spacious private single bedroom with private ensuite.</p> <p>Private access door, leading to our beautifully landscaped gardens, or courtyard.</p>

**Accommodations Charges**

<b>RAD -</b> Refundable Accommodation Deposit	\$435,000	\$460,000	\$510,000
<b>DAP –</b> Daily Accommodation Payment*	\$47.79	\$50.54	\$56.03

**Example combination**

50% RAD	\$217,500	\$230,000	\$255,000
50% DAP	\$23.90	\$25.27	\$28.02

*\*The DAP is indexed at the Maximum Permissible Interest Rate set by the Government (example based on 4.01% as at 1 Oct 2021 & updated quarterly)*

## Aged Care Accommodation Charges

**Accommodation Charge** – An accommodation charge is a daily amount that you pay towards your accommodation in an aged care home. Your accommodation charge is determined when you first enter a home.

**Residents can pay for their Accommodation in one of the following ways:**

Accommodation	Description	How Do I Pay?	Abbreviation
No accommodation costs	If your income and assets are below a certain amount, the Australian Government will pay your accommodation costs.		
An accommodation contribution	If you need to pay for part of your accommodation, the Australian Government will pay the rest.	You can choose to pay: <ul style="list-style-type: none"> <li>– a lump-sum 'refundable accommodation contribution'</li> <li>– rental-style payments called a 'daily accommodation contribution' or</li> <li>– a combination of both.</li> </ul>	RAC DAC RAC/DAC
An accommodation payment	A combination payment includes both a partial lump sum and daily accommodation payment.	You can choose to pay: <ul style="list-style-type: none"> <li>– a lump-sum 'refundable accommodation deposit'</li> <li>– rental-style payments called a 'daily accommodation payment' or</li> <li>– a combination of both.</li> </ul>	RAD DAP RAD/DAP

## Other Aged Care Fees and Charges

**The Daily Fee** is charged to every resident in aged care, the daily cost is set by the Department of Human Services and is revised on the 20<sup>th</sup> of March and 20<sup>th</sup> of September – each year. (This amount is set at 85 % of the aged pension).

**Means Tested Care Fee (MTCF)** – The MTCF is an additional contribution towards the cost of care that some people may be asked to pay. The Department of Human Services will work out if you are required to pay this fee based on the assessment of your Assets and Income Assessment.

**Additional Services Fee** - This fee is for services which are considered more than the standard level of service. Embracia charges an Additional Service fee for a package of multiple items that must be purchased together.

**Personal Services** - Embracia offers other optional personal services which are available for your selection. These are not means tested. These services are charged individually, and can include telephone connection to your room.



*For additional information on Residential Aged Care refer to:*

My Aged Care – 1800 200 422  
[www.myagedcare.gov.au](http://www.myagedcare.gov.au)

Services Australia – 1800 227 475  
[www.servicesaustralia.gov.au](http://www.servicesaustralia.gov.au)